

BETONABDECKUNG
 2.00/1.30/0.24

NZ_B_029

Massstab : 1:20 Datum : Sept. 2010
 Bearbeitet : EM Gesehen : CR

Grundriss 1:20

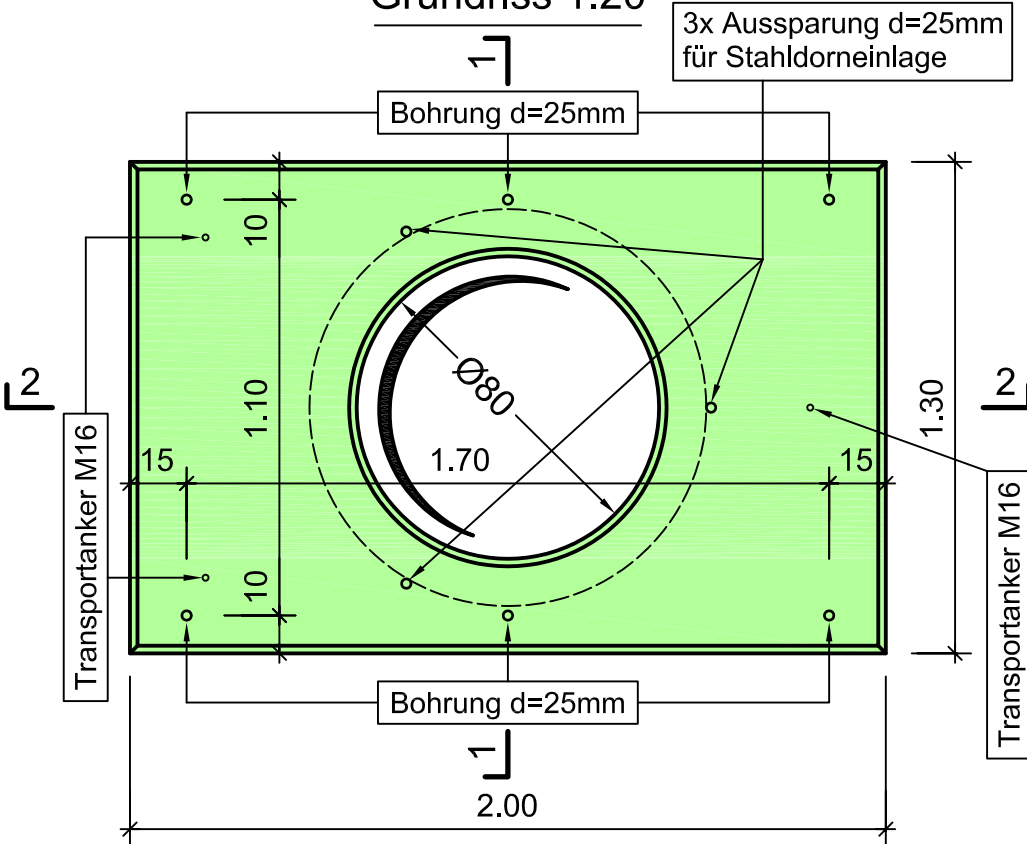

Konstruktionsbeton:

C 25/30
 CEM I 52.5 325kg/m³

Auflager (best. Schacht):

Mauerkrone reinigen
 und falls nötig mit
 mit Mörtel ausgleichen

Elementgewicht:

1260 kg

zulässige Belastung:

ca. 40cm überdeckt
 Radlast 150 kN

Schnitt 1 - 1 1:20

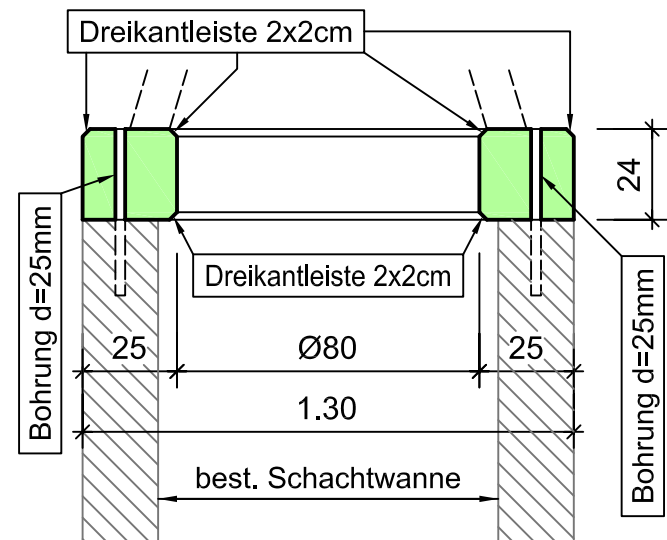

Schnitt 2 - 2 1:20

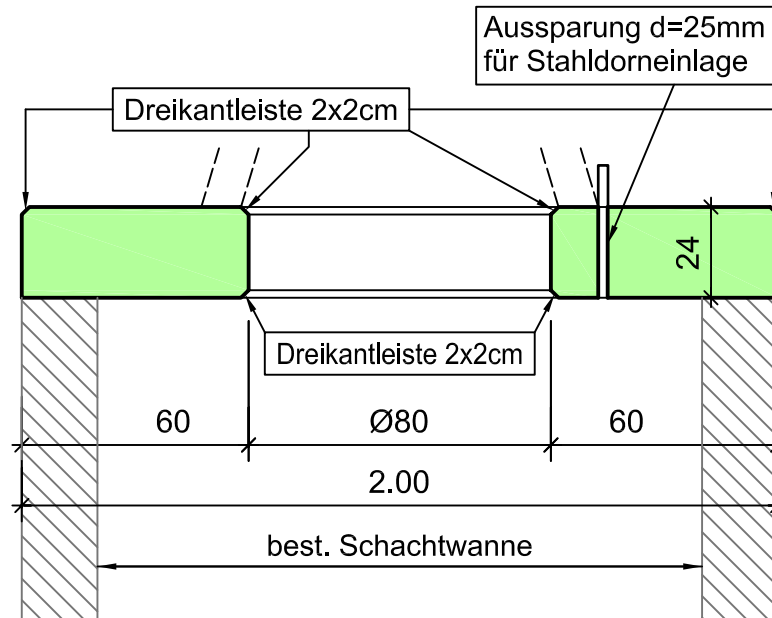

Grundriss 1:20

Armierung

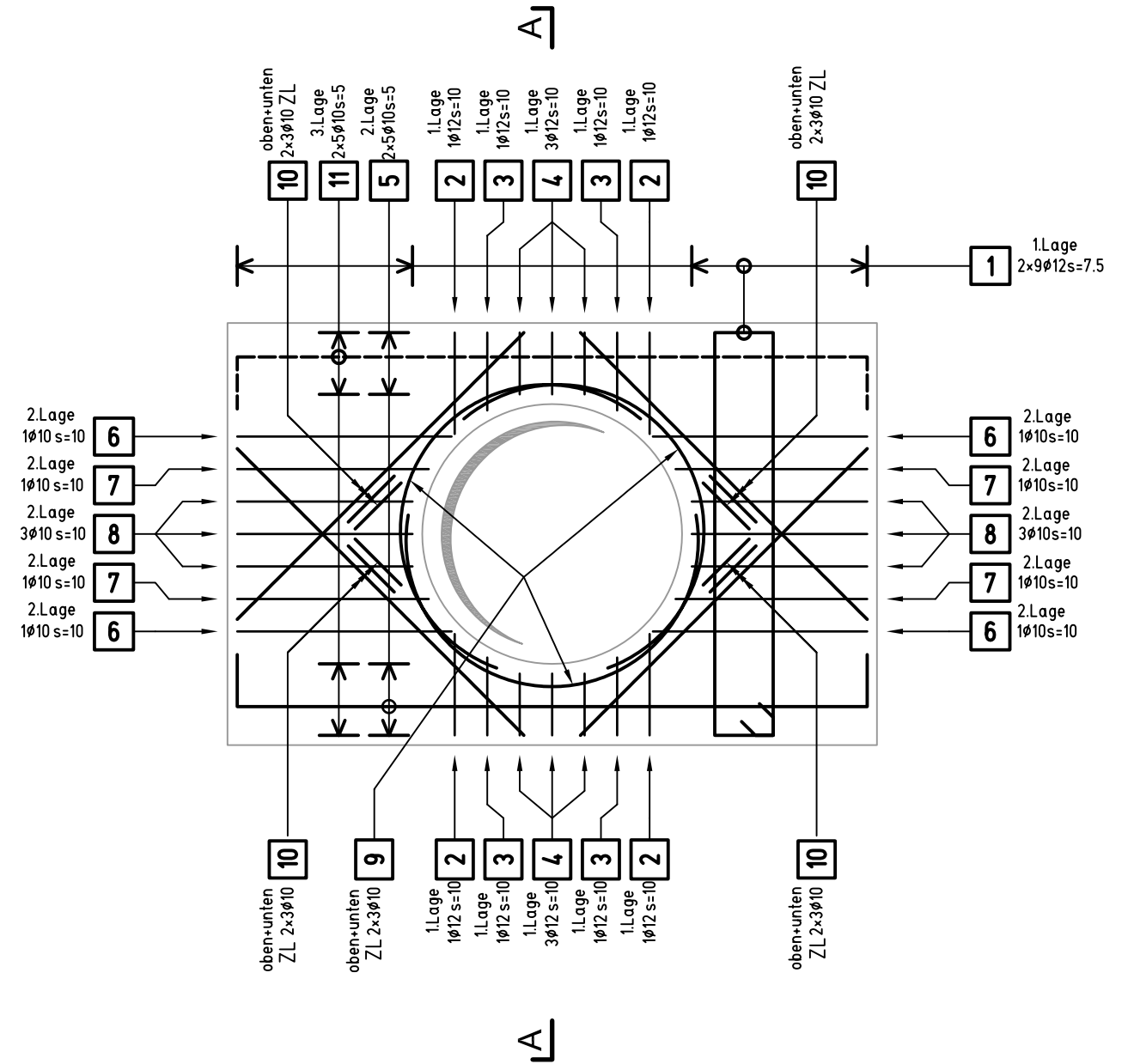

3cm Eisenüberdeckung

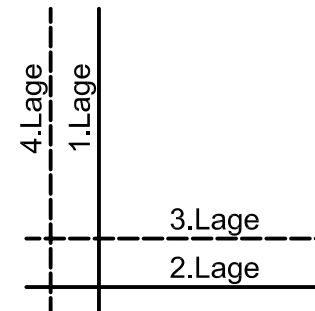

Schnitt A - A 1:20

Armierung

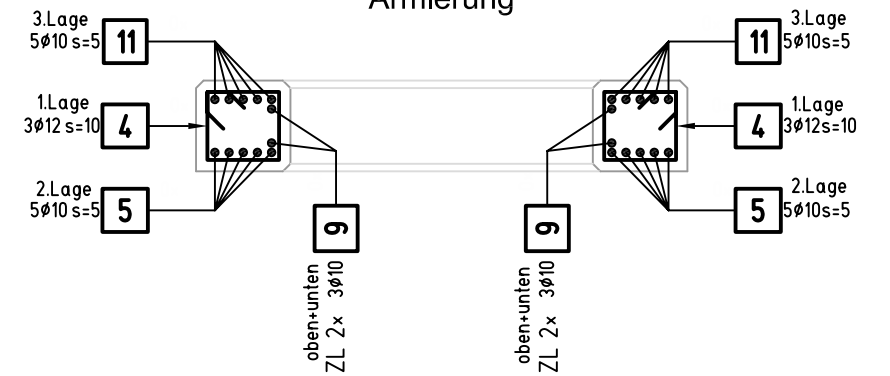

| | | | | | | |
|---------------------|---|---|---|---------------------|-------|------------|
| BAUOBJEKT | Liechtensteinische Kraftwerke Im alten Riet 17, FL-9494 Schaan Tel. +423 236 01 11, Fax +423 236 01 12 lkw@lkw.li, www.lkw.li |  | BETONSTAHLLISTE NR. NZ_B_029_EL | | | |
| | BETONABDECKUNG 2.00/1.30/0.24 | ZU PLAN NR. NZ_B_029 | <table border="1" style="width: 100%; border-collapse: collapse;"> <tr> <td style="width: 50%; padding: 2px;">Datum Sept. 2010</td> <td style="width: 50%; padding: 2px;">Gepr.</td> </tr> <tr> <td style="padding: 2px;">Gez. EM</td> <td style="padding: 2px;">Rev.</td> </tr> </table> | Datum Sept. 2010 | Gepr. | Gez. EM |
| Datum Sept. 2010 | Gepr. | | | | | |
| Gez. EM | Rev. | | | | | |
| BAUUNT. | | BETONSTAHL GEMÄSS SIA-NORM 262 ERGÄNZUNG 262/1 | | | | |
| INGENIEUR |  | | Büro Schaan, Schmedgässle 2, FL-9494 Schaan Tel: +423 237 50 80 / Fax: +423 237 50 81 Büro Ruggell, Noflerstrasse 12, FL-9491 Ruggell Tel: +423 370 18 90 / Fax: +423 370 18 94 | | | |
| | info@bauingenieure.li www.bauingenieure.li | | | | | |

| ZUSAMMENFASSUNG | | | | | | | | | |
|----------------------|------------|---------------|---------------------------|------------------------|----------------|------------|--------------------|----------------|--|
| Fix- und Lagerlängen | | | Meter- Gewicht kg/m | Durch- messer mm | Bearbeitet | | | | |
| Anzahl Pos. | Länge m | Gewicht kg | | | Anzahl Pos. | Länge m | Gewicht kg | | |
| 1 | 30.00 | 18.510 | 0.617 | 10 | 6 | 78.66 | 48.533 | | |
| | | | 0.888 | 12 | 4 | 72.44 | 64.327 | | |
| 1 | Gesamt | 18.510 | | | 10 | Gesamt | 112.860 | | |
| | | | | | | | GESAMTMENGE | 131.370 | |

| Abstandhalter | | | | Stützbügel | |
|----------------------------|-----------|---------------|---------|------------|---------|
| Typ | Stückzahl | Länge Total m | Höhe cm | Stückzahl | Höhe cm |
| STÜTZBÜGEL-H180MM-MIT-FUSS | 4 | 10.00 | 18.0 | | |

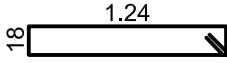
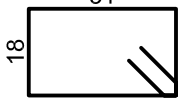
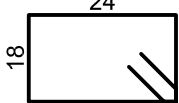
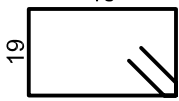
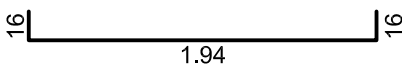
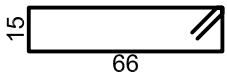
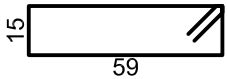
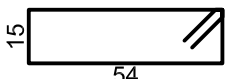
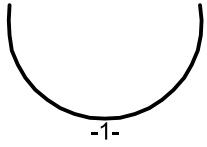
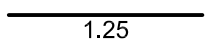
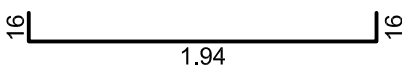
| Pos. | Stk. | d | Länge | Ges.L | Gewicht kg | Biegeform |
|------|------|----|-------|-------|---------------|---|
| 1 | 18 | 12 | 3.14 | 56.52 | 50.190 |  Hakenlänge= 15.0 |
| 2 | 4 | 12 | 1.28 | 5.12 | 4.547 |  Hakenlänge= 15.0 |
| 3 | 4 | 12 | 1.14 | 4.56 | 4.049 |  Hakenlänge= 15.0 |
| 4 | 6 | 12 | 1.04 | 6.24 | 5.541 |  Hakenlänge= 15.0 |
| 5 | 10 | 10 | 2.26 | 22.60 | 13.944 |  Hakenlänge= 12.0 |
| 6 | 4 | 10 | 1.86 | 7.44 | 4.590 |  Hakenlänge= 12.0 |
| 7 | 4 | 10 | 1.72 | 6.88 | 4.245 |  Hakenlänge= 12.0 |
| 8 | 6 | 10 | 1.62 | 9.72 | 5.997 |  Hakenlänge= 12.0 |
| 9 | 6 | 10 | 1.57 | 9.42 | 5.812 |  Nr. dx dy l >° r Sehne ab 1 0.89 -0.00 1.57 0 0.45 0.89 0.53 |
| 10 | 24 | 10 | 1.25 | 30.00 | 18.510 |  |
| 11 | 10 | 10 | 2.26 | 22.60 | 13.944 |  Hakenlänge= 12.0 |